



Sounder Yard and Shops Project



Capital Committee
May 12, 2016

Maintenance Base Requirements

- Close proximity and access to mainline railroad right of way
- Project site that could accommodate the Sounder fleet and its facilities with modest growth
- Affordability



Preferred Site in Lakewood, WA

- Property owned by Sound Transit
- Compatible to Land Use Zoning in area
- Cost Effective
- Sounder Yard Expansion begins construction in 2016

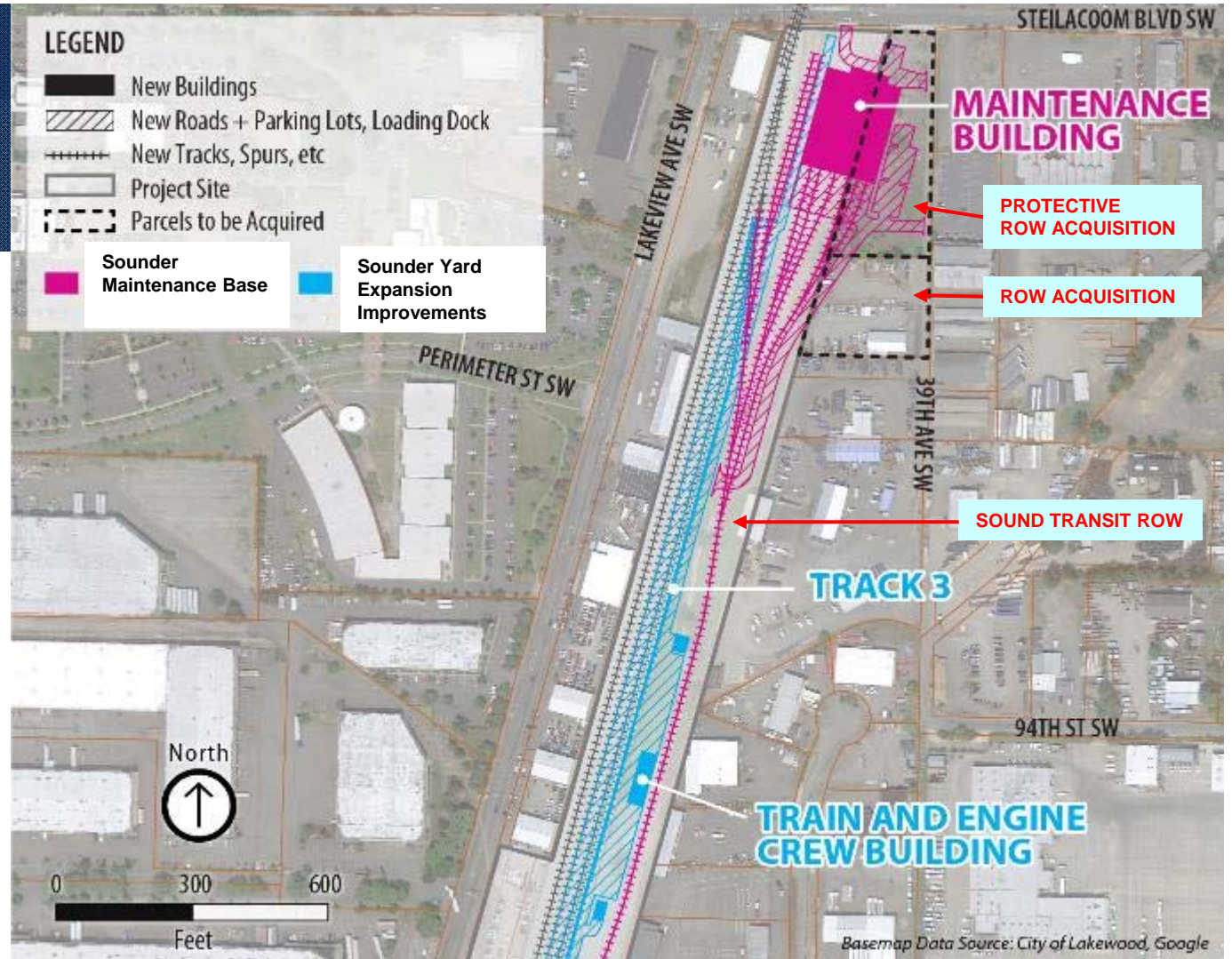

Summary of Lifetime Budget

\$150M Sounder Yard & Shops ST2 Finance Plan (\$2015)

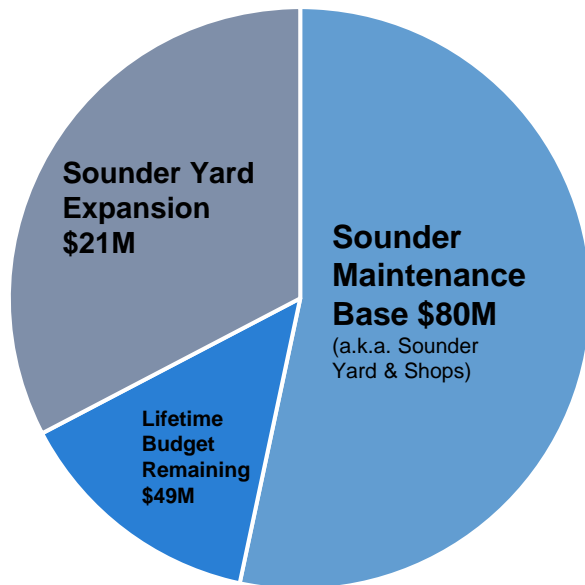

Sounder Yard and Shops Maintenance Operations

- Seven train sets to be stored at the facility.
- Night time maintenance crews to work between 8pm to 4am
- ST anticipates a maximum of 24 nighttime crossings of 100th Street SW per week, with a very conservative assumption of 12 per night, for purposes for environmental analyses

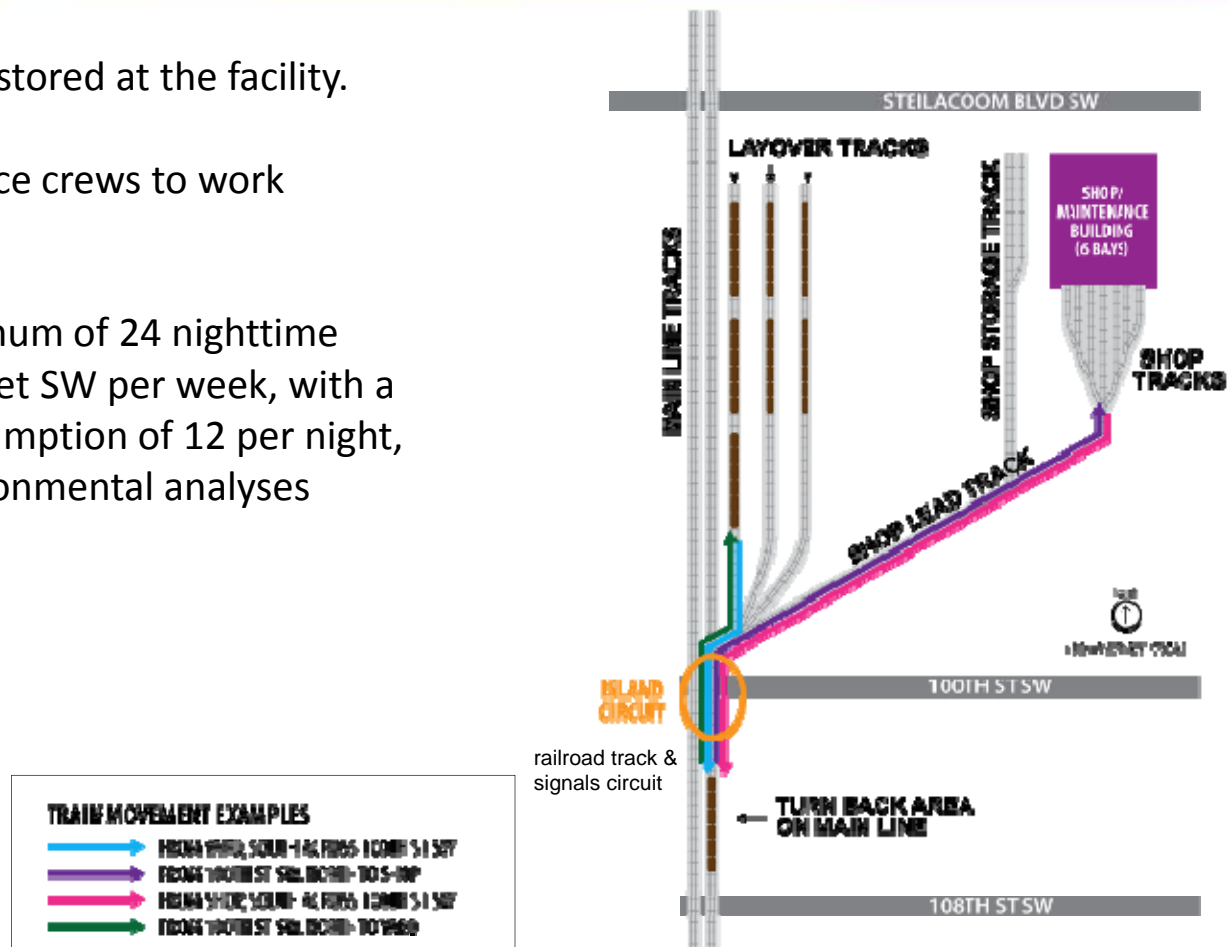

Environmental Review for Yard and Shops



- FTA issued NEPA approval in December 2015 for protective acquisition of the private parcel
- FTA issued NEPA approval in January 2016 for the Sounder Yard and Shops Facility Project
- SEPA Determination of Non Significance issued 3/25/16, public comment period ended 4/8/16
- Up to 16 moderate noise impacts to be reassessed in final design and mitigated





 **SOUNDTRANSIT**
RIDE THE WAVE

